

Town of Langford Building Permit Application

APPLICANT		REQUIREMENTS FOR SET-BACK FROM RIGHT-OF-WAY	
Name:		Front yard or North/South exposure - 30 ft	
Mailing Address:		Rear yard set-back from alley ROW - 7 ft	
City:	State: Zip:	Side yard set-back from lot line - 7 ft	
Phone:		Corner Lot or East/West exposure - 15 ft	
PROPERTY INFORMATION		CONTRACTOR / CARPENTER	
Legal Owner:		Name:	
Property Address:		Address:	
Block:	Lot(s):		
Parcel ID:		Phone:	

TYPE OF IMPROVEMENT
<input type="checkbox"/> New Building <input type="checkbox"/> Addition <input type="checkbox"/> Move <input type="checkbox"/> Remodel/Repair <input type="checkbox"/> Mobile Home <input type="checkbox"/> Removal <input type="checkbox"/> Other: _____ <input checked="" type="checkbox"/> Residential - <input type="checkbox"/> Commercial Type of Construction: _____ Size: _____ Sidewall Height: _____ Estimated Total Cost: \$ _____ <small>(include concrete, finish, etc.)</small> Use of Proposed Structure: _____

SIGNATURES
<p>The owner of this building and the applicant of this permit agree to conform to all applicable ordinances of the Town of Langford, SD.</p> _____ Owner's Signature Date: _____ _____ Applicant's Signature Date: _____

DRAWING INSTRUCTIONS - SKETCH AND DIMENSIONS OF PROJECT REQUIRED

- 1.) Insert street name
- 2.) Draw in your lot line
- 3.) Draw in the box to indicate your bldg footprint
- 4.) Indicate set-backs on drawing
 - A. Front facing N/S - _____ ft
 - B. Rear - _____ ft
 - C. Side - _____ ft
 - D. Corner lot facing E/W _____ ft

Most street ROW's are 66 feet
All alley ROW's are 20 feet
- 5.) Removal of any bldgs yes no
- 6.) Residential - Commercial

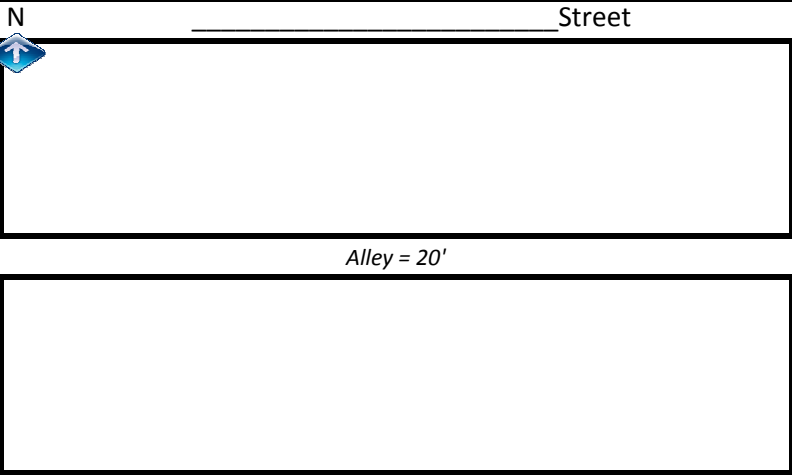

Application is hereby: Approved Denied

_____ Board President signature

Date: _____

Reason for Denial:

PERMIT MUST BE APPROVED BEFORE CONSTRUCTION BEGINS
PLEASE ALLOW UP TO 30 DAYS FOR APPROVAL
\$50.00 FINE FOR FAILURE TO SECURE A PERMIT
PROJECT MUST BEGIN WITH ONE (1) YEAR OF PERMIT APPROVAL OR PERMIT BECOMES NULL AND VOID